



# Guide to Courses & Rules

Roy G  
Zilker  
Circle C  
Swordstone  
Flying Armadillo

Northtown  
Wilco  
Manor  
Searight  
Benbrook

Kyle Maute, Tournament Director

303-520-0574

**General**

All park boundaries are Out of Bound (OB).  
No two-meter rule. Normal OB / missed mando penalties apply.

**Holes with Specific Rules or Notes**

Note the word "flagged" also denotes other types of marking such as paint or string.

- 3 OB: Park boundary line right defined by construction fencing. *MA1 plays from the long tees. FA1 plays from short tees.*
- 5 OB: Park boundary line long.
- 6 OB: Park boundary line left.
- 9 OB: Park boundary line left.

Rules of Disc Golf (PDGA)

**806.03 Casual Area**

Last updated: Saturday, December 31, 2022 - 22:58

- A. A casual area is casual water, or any area specifically designated as a casual area by the Director before the round. Casual water is any body of water that is in-bounds and has not been explicitly declared by the Director to be in play.
- B. To obtain relief from a casual area, the player's lie may be relocated without penalty to the nearest lie which is farther from the target and is on the line of play, at the nearest point that provides relief (unless greater casual relief is announced by the Director).
- C. A player who takes relief other than as allowed by rule receives one penalty throw.

Notes

---

---

---

---

---

---

---

---

---

---

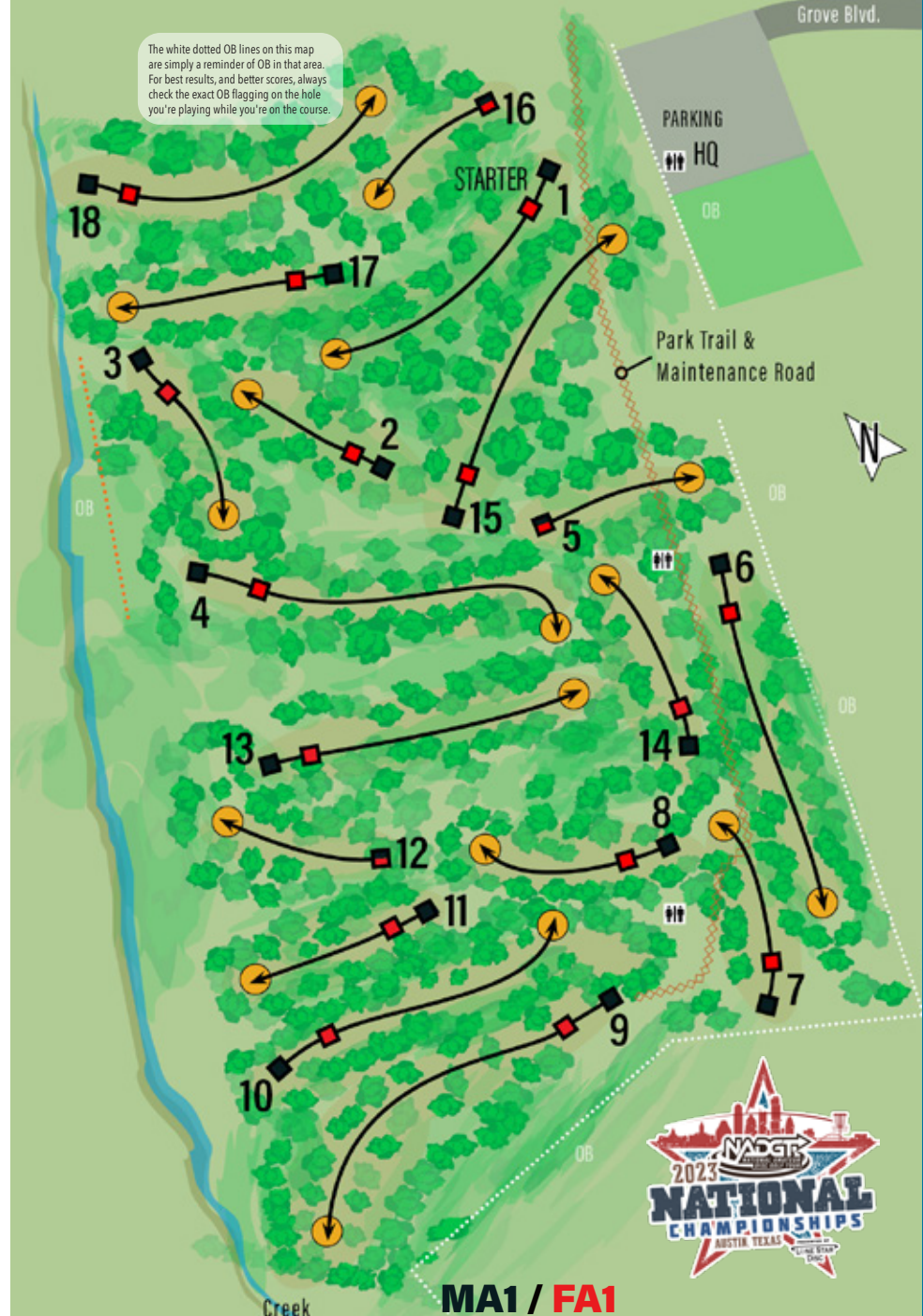

**MA1 / FA1**

Hole	1	2	3	4	5	6	7	8	9	10	11	12	13	14	15	16	17	18	Total
Ft	593	322	386	708	325	745	351	373	672	611	368	310	693	273	699	338	440	705	8912
Par	4	3	3	4	3	4	3	3	4	4	3	3	4	3	4	3	3	4	62
Hole Ft	493	258	328	591	325	652	310	314	611	541	316	310	564	341	591	338	340	621	7844
Ft	4	3	3	4	3	4	3	3	4	4	3	3	4	3	4	3	3	4	62

**General**

On or beyond sidewalks or roads is OB **except** holes 6 and 7 where beyond the road bisecting the fairway is in-bounds (on the road is OB). • Hole 16 is an isolated Island Hole. Any throw from surrounding holes that finishes within the flagged area of 16 Island is OB  
 • No two-meter rule. • Normal OB / missed mando penalties apply.

**Holes with Specific Rules or Notes**

Note the word "flagged" also denotes other types of marking such as paint or string.

- 1 Inside the fenced area left of the fairway is OB. Proceed to DZ. Note: You may take 2 meters relief for any inbounds throw landing near the fence.
  - 4 **Mando:** Must throw right of the flagged tree. DZ is adjacent to the Mando tree.
  - 6 On the road bisecting the fairway is OB.
  - 7 **Mando:** Must throw left of the flagged tree. DZ is adjacent to the Mando tree. On the road bisecting the fairway is OB; on or beyond the road running along the fairway on the right is OB.
  - 15 **Mando:** Must throw left of the flagged tree. DZ is adjacent to the Mando tree.
  - 16 Island Hole. Any throw finishing outside the flagged boundary is OB.
  - 17 "Additional Parking" area is flagged OB.
- Any throw from surrounding holes that finishes within the flagged area of 16 Island is OB.**

Thanks To:



Over \$176,000 Raised for Austin Ronald McDonald House Since 1999



**MA60 / FA40 / FA50 / FA2 / FA3**

Hole	1	2	3	4	5	6	7	8	9	10	11	12	13	14	15	16	17	18	Total
Ft	245	240	244	311	232	225	353	281	188	367	248	259	325	264	309	291	318	307	5007
Par	3	3	3	3	3	3	3	3	3	3	3	3	3	3	3	3	3	3	54

**General**

Past any park boundaries is Out of Bounds (OB). • No two-meter rule.  
Normal OB / missed mando penalties apply.

**Hole with Specific Rules or Notes**

Note the word "flagged" also denotes other types of marking such as paint or string.

12 *Use the short tee pad.*

18 Dry creek bed in front of green is flagged OB. If throw comes to rest OB, Proceed to where last in bounds for next throw (normal OB rules).

Rules of Disc Golf (PDGA)

**806.03 Casual Area**

Last updated: Saturday, December 31, 2022 - 22:58

- A. A casual area is casual water, or any area specifically designated as a casual area by the Director before the round. Casual water is any body of water that is in-bounds and has not been explicitly declared by the Director to be in play.
- B. To obtain relief from a casual area, the player's lie may be relocated without penalty to the nearest lie which is farther from the target and is on the line of play, at the nearest point that provides relief (unless greater casual relief is announced by the Director).
- C. A player who takes relief other than as allowed by rule receives one penalty throw.

*Notes*

---

---

---

---

---

---

---

---

*Thanks To:*



**MA1 / FA1**

Hole	1	2	3	4	5	6	7	8	9	10	11	12	13	14	15	16	17	18	Total
<b>Ft</b>	540	215	231	188	815	492	225	290	240	280	630	450	304	610	255	609	307	788	7469
<b>Par</b>	4	3	3	3	5	4	3	3	3	3	4	4	3	4	3	4	3	5	64
<b>Ft</b>	440	179	207	188	677	438	225	228	240	280	552	450	252	485	207	495	247	722	6512
<b>Par</b>	4	3	3	3	5	4	3	3	3	3	4	4	3	4	3	4	3	5	64

**General**

Out of Bounds (OB): All **Vineyards** as defined by the bottom wire on their long sides and by paint/ flags line on their short sides. If your disc lands within the four corners of any vineyard play according to normal OB rules. • **Paved Roads:** Play them as OB rivers unless otherwise noted. • Outside of property boundaries is OB. • No two-meter rule. • Normal OB / missed mando penalties apply.

**Holes with Specific Rules or Notes**

Note the word "flagged" also denotes other types of marking such as paint or string.

- 3 Fountain and circular area surrounding fountain is OB. Stairs and sidewalk ARE NOT OB. If OB in fountain area, proceed to DZ with penalty. Paved road behind green is in-bounds up until the painted line. You may NOT play from the stone wall. If your stance would be on the wall, it is treated as a Casual Area (806.03) and you must relocate to the nearest lie, which is farther from the target and is on the line of play, at the nearest point that provides relief. Disc must be 100% surrounded by grass to not require relief. (PDGA Waivers Granted).
- 4 Road on the right and beyond is OB.
- 5 Road and beyond on right is OB.
- 7 Road and beyond on left is OB.
- 8 **Mando:** Triple mando. Missed mando, proceed to DZ. Paved road and beyond is OB.
- 9 Beyond the white flag line is OB. Inside the enclosed stone tree beds, (marked by colored flags) is not OB. Take casual relief from either of these areas (no penalty).  
**Do not enter OB area. Staff will retrieve and turn into tournament central after rounds.**
- 10 Inside the flagged pond area is OB. If your drive is OB, proceed to the Drop Zone. (1 stroke penalty) There is also an OB area behind the basket. Normal OB rules apply to this area.  
**Do not enter OB area. Staff will retrieve and turn into tournament central after rounds.**
- 11 **Mando:** Triple mando. Missed mando, proceed to DZ.
- 13 Road and beyond is OB.
- 14 **Island Green:** Disc must come to rest on Island (past paved road). OB throws proceed to DZ.
- 16 You are playing from the short tee to the long basket.
- 17 **Island Green:** Disc must come to rest on Island (past paved road). OB throws proceed to DZ.
- 18 Paved road on right side of fairway and beyond is OB.



MA3

Hole	1	2	3	4	5	6	7	8	9	10	11	12	13	14	15	16	17	18	Total
Ft	252	421	408	357	290	420	280	177	231	296	219	261	439	249	311	373	186	444	5614
Par	3	4	3	4	3	3	3	3	3	3	3	3	4	3	3	3	3	4	58



Thanks To:  
Swordstone  
Disc Golf Club

#### General

Past any property boundary is Out of Bounds (OB). • No two-meter rule.  
Normal OB / missed mando penalties apply.

#### Holes with Specific Rules or Notes

Note the word "flagged" also denotes other types of marking such as paint or string.

- 6 **Mando:** Triple mando immediately off tee pad. Missed mando, re-tee with one penalty throw. The tee pad is the Drop Zone (DZ).
- 7 Past the property boundary beyond basket is OB.
- 8 Past the property boundary on right is OB.
- 14 **Mando:** Triple mando immediately off tee pad. Missed mando, re-tee with one penalty throw. The tee pad is the DZ.
- 15 **Mando:** Triple mando immediately off tee pad. Missed mando, re-tee with one penalty throw. The tee pad is the DZ.
- 18 The basket area is flagged as an **Island Green:** Any tee throw that does not stay on the green, proceed to DZ with one penalty throw.

#### Rules of Disc Golf (PDGA)

##### 806.03 Casual Area

Last updated: Saturday, December 31, 2022 - 22:58

- A. A casual area is casual water, or any area specifically designated as a casual area by the Director before the round. Casual water is any body of water that is in-bounds and has not been explicitly declared by the Director to be in play.
- B. To obtain relief from a casual area, the player's lie may be relocated without penalty to the nearest lie which is farther from the target and is on the line of play, at the nearest point that provides relief (unless greater casual relief is announced by the Director).
- C. A player who takes relief other than as allowed by rule receives one penalty throw.

Thanks To:



The white dotted OB lines on this map are simply a reminder of OB in that area. For best results, and better scores, always check the exact OB flagging on the hole you're playing while you're on the course.

### MA3

Hole	1	2	3	4	5	6	7	8	9	10	11	12	13	14	15	16	17	18	Total
Ft	250	280	235	250	315	190	245	380	395	240	280	230	225	225	150	430	495	200	5015
Par	3	3	3	3	3	3	3	4	4	3	3	3	3	3	3	4	4	3	58

### General

Out of Bounds (OB): Beyond park boundaries; dog park, playgrounds, parking lot, pavilion.  
No two-meter rule. • Normal OB / missed mando penalties apply.

### Holes with Specific Rules or Notes

Note the word "flagged" also denotes other types of marking such as paint or string.

- 1 On or beyond path on right is OB.
- 2 On or beyond path on right is OB. Note: the partial sidewalk behind the basket is NOT OB.
- 3 On or beyond path on right is OB. • OB flagged line on left and long.
- 4 OB flagged line on left; and along creek on right. In or beyond flags/creek is OB.
- 5 OB flagged line along creek on right. In or beyond flags/creek is OB.
- 6 On or beyond path on right is OB.
- 7 On or beyond path on left is OB. • OB flagged line on right.
- 8 **Island Green:** If disc not come to rest on island green, proceed to DZ with penalty.
- 9 **Mando:** Must pass right of tree immediately off of tee. Missed mando re-tee with penalty. The tee pad is the DZ. • OB flagged line on left along creek. In or beyond flags/creek is OB. • Creek becomes a "river" past turn marked by orange flags. Play from where last in bounds with penalty. • On or beyond path deep is OB.
- 10 On or beyond path on left is OB. • OB flagged line on right.
- 11 USE THE SHORT TEE  
On or beyond path on left is OB. • OB flagged line on right.
- 12 Flagged pond is OB. If OB on drive must proceed to DZ1 (short pad) with penalty. If shot from DZ1 is OB, proceed to DZ2 with penalty. (If you are throwing from DZ2 because of OBs you are lying 4 and throwing 5).
- 13 **Mando:** Must pass left of telephone pole. Missed mando proceed to DZ which is adjacent to pole with penalty. • OB flagged line along creek on left. In or beyond flags/creek is OB.
- 14 In flagged pond/wetland is OB. If OB you have these options with penalty:  
a) Proceed to DZ. The drop zone is near the telephone pole left of the pond.  
-OR- b) Proceed to where disc was last in bounds. -OR- c) Re-tee with penalty. • On or beyond sidewalk on right is OB.
- 15 On or beyond concrete path on right is OB. • OB flagged line past basket. on right.
- 16 **Island Green:** If disc not come to rest on island green, proceed to DZ with penalty.
- 17 On or beyond concrete path on right is OB. • OB flagged line on left along creek. In or beyond flags/creek is OB.
- 18 OB flagged line along on right. • On or beyond concrete path on left is OB.



The white dotted OB lines on this map are simply a reminder of OB in that area. For best results, and better scores, always check the exact OB flagging on the hole you're playing while you're on the course.

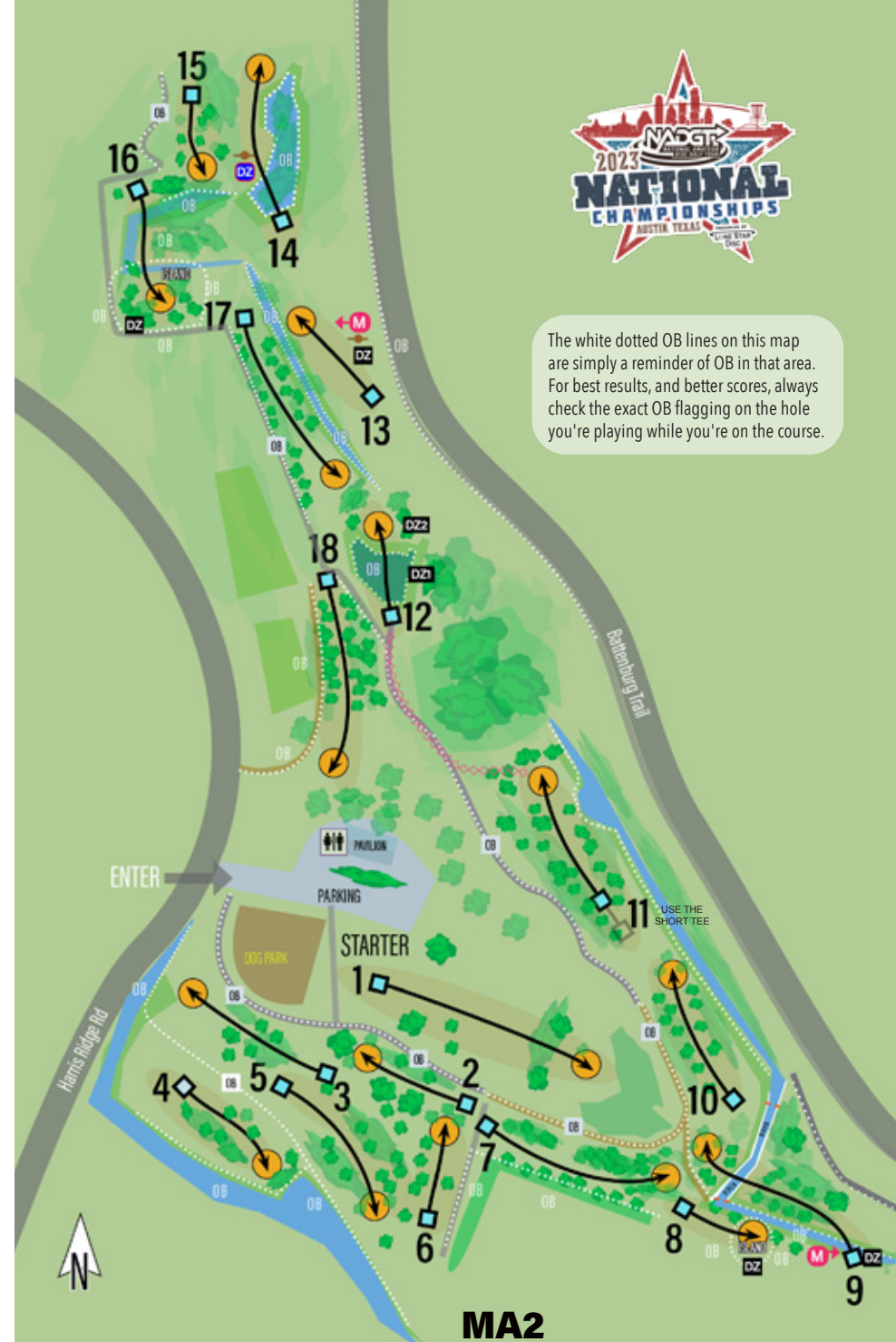

### MA2

Hole	1	2	3	4	5	6	7	8	9	10	11	12	13	14	15	16	17	18	Total
Ft	580	320	327	269	328	280	593	184	513	336	498	201	197	333	241	234	325	326	5935
Par	4	3	3	3	3	3	4	3	4	3	4	3	3	3	3	3	3	4	59

Thanks To:



**General**

Out of Bounds (OB): Beyond park property. • No two-meter rule.  
Normal OB / missed mando penalties apply.

**Holes with Specific Rules or Notes**

- 1 **Please wait** until players on #2 have teed off before starting your round. The parking lot far right of the basket is OB.
- 5 **Mando:** Keep left of mando directly off the tee pad. Missed mando re-tee (the tee pad is the DZ).
- 6 **Please wait** until players on #7 have teed off before teeing off.
- 7 **Mando:** Keep left of mando directly off the tee pad. Missed mando re-tee (the tee pad is the DZ).
- 8 **Mando:** Double mando. Missed mando, proceed to the DZ.



Additional Restrooms

Thanks To:



Rules of Disc Golf (PDGA)

**806.03 Casual Area**

Last updated: Saturday, December 31, 2022 - 22:58

- A. A casual area is casual water, or any area specifically designated as a casual area by the Director before the round. Casual water is any body of water that is in-bounds and has not been explicitly declared by the Director to be in play.
- B. To obtain relief from a casual area, the player's lie may be relocated without penalty to the nearest lie which is farther from the target and is on the line of play, at the nearest point that provides relief (unless greater casual relief is announced by the Director).
- C. A player who takes relief other than as allowed by rule receives one penalty throw.



**MA40 / MA50**

Hole	1	2	3	4	5	6	7	8	9	10	11	12	13	14	15	16	17	18	Total
Ft	255	600	545	215	560	360	275	325	795	205	240	230	560	350	395	360	550	290	7110
Par	3	4	4	3	4	3	3	3	5	3	3	3	4	3	3	3	4	3	61



**General**

**Play from the Short Tees (Red).**

Painted/Flagged White lines indicate OB; Normal OB rules apply.

Painted/Yellow Flagged lines indicate Casual relief area.

Any water not marked with white or orange lines will be played as casual.

**Holes with Specific Rules or Notes**

Note the word "flagged" also denotes other types of marking such as paint or string.

- |   |   |
|---|---|
| 1 No OB   | 9 Creek water is Casual.  |
| 2 Creek and beyond is OB.   | 10 Ditch in front of the basket is Casual relief. If your disc lands in said area, proceed to Casual DZ on the concrete bridge with NO penalty. |
| 3 Creek and beyond is OB.   | 11 Creek left and beyond is OB.   |
| 4 Creek is flagged OB. Normal OB rules apply.   | 12 Creek water is Casual.   |
| 5 <b>Plays as an island.</b> Any Tee throw not landing inbounds will proceed to the drop zone, located between the tee and basket. Any subsequent OB will play from last spot inbounds. | 15 Inside fenced areas is OB.   |
| 6 Creek and beyond on the right is OB.  | 17 Sidewalk right and beyond is OB.   |
| 8 Creek water is Casual.  | 18 Sidewalk right and beyond is OB.   |

Rules of Disc Golf (PDGA)

**806.03 Casual Area**

Last updated: Saturday, December 31, 2022 - 22:58

- A. A casual area is casual water, or any area specifically designated as a casual area by the Director before the round. Casual water is any body of water that is in-bounds and has not been explicitly declared by the Director to be in play.
- B. To obtain relief from a casual area, the player's lie may be relocated without penalty to the nearest lie which is farther from the target and is on the line of play, at the nearest point that provides relief (unless greater casual relief is announced by the Director).
- C. A player who takes relief other than as allowed by rule receives one penalty throw.



Thanks To:

*For Staffing Manor  
NADGT Finals Course*

**BARTHOLOMEW**  
*Disc Golf Club*



**MA2**

Hole	1	2	3	4	5	6	7	8	9	10	11	12	13	14	15	16	17	18	Total
Ft	503	244	274	425	192	211	456	674	229	421	213	377	250	170	358	271	502	468	6238
Par	4	3	3	4	3	3	4	4	3	4	3	4	3	3	4	3	4	4	63



**General**

Past any property boundary is Out of Bounds (OB). • No two-meter rule.  
Normal OB / missed mando penalties apply.

***No trespassing beyond fences in private property!***

**Holes with Specific Rules or Notes**

Note the word "flagged" also denotes other types of marking such as paint or string.

- 1 Triple MANDO - archway (Drop Zone in archway), OB - high grass & beyond to the right, creek & beyond to the left.
- 2 OB - creek & beyond to the left, high grass & beyond to the right.
- 3 OB - creek & beyond to the right.
- 4 OB - creek & beyond to the left & behind the basket, on top of stone retaining wall & beyond to the right, pond in front of basket.
- 5 OB - high grass & beyond to the left, creek & beyond to the right.
- 6 OB - creek & beyond, high grass & beyond to the right.
- 7 OB - walking path & beyond to the left, high grass & beyond.
- 8 OB - creek & beyond to the left, walking path & beyond to the right.
- 9 MANDO - left of tree (Drop Zone 2 meters left of tree), OB - creek & beyond to the left, walking path & beyond to the right.
- 10 MANDO - right of tree (Drop Zone 2 meters right of tree), OB - creek & beyond to the left, beyond fences in private property.
- 11 OB - creek & beyond to the left, beyond fences in private property.
- 12 OB - creek & beyond to the left.
- 14 OB - creek & beyond behind the basket.
- 15 OB - high grass & beyond to the right.
- 16 MANDO - left of tree (Drop Zone 2 meters left of tree), OB - creek & beyond to the left.
- 17 OB - creek & beyond to the left & behind the basket.
- 18 OB - creek, parking lot.



*Thanks To:*

The white dotted OB lines on this map are simply a reminder of OB in that area. For best results, and better scores, always check the exact OB flagging on the hole you're playing while you're on the course.

**2023 NADGR NATIONAL CHAMPIONSHIPS**  
AUSTIN, TEXAS

**ADDITIONAL PARKING & RESTROOMS**

**PARKING & RESTROOMS**

**MA40 / MA50**

Hole	1	2	3	4	5	6	7	8	9	10	11	12	13	14	15	16	17	18	Total
Ft	480	280	240	555	610	240	310	315	255	505	200	540	265	230	640	305	345	545	6860
Par	4	3	3	4	4	3	3	3	3	4	3	4	3	3	4	3	3	4	61